

R/V Yellowfin Social Distancing Plan

40 Guest Max
3 Crew members
Total persons aboard 43

Legend

- Outside Areas. Masks required. Includes life vest chest deck behind bridge,
- Head and outside sink. Disinfect after use.
- Galley & wetlab. Masks required unless used for meals on long trips. IF eating or drinking then 6-foot social distancing applies. First bunkroom on right may be used for backpacks
- Off Limits: kitchen in galley, bridge and engine room. Refrigerator is not for guests.

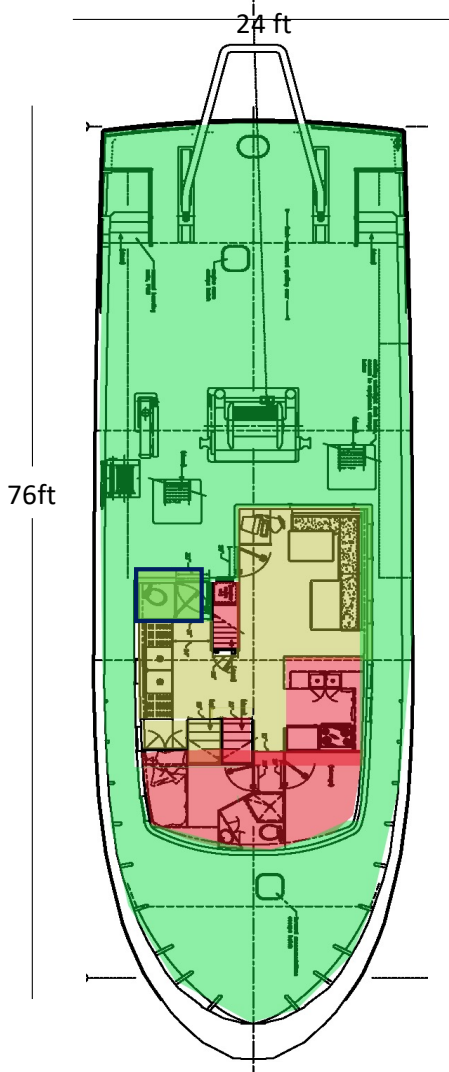

All persons aboard are strongly recommended to wear masks and must wear closed toed shoes.

Students/Researchers should line up on the designated markers along the wharf no more than 30 minutes before the start of the cruise. No one should be gathered on the dock or gangway before the cruise start time.

Students/Researchers will be checked in one at a time before boarding the R/V Yellowfin. The check in will consist of signing the vessel manifest.

Areas that are off limits are: the bridge, the engine room, the kitchen part of the galley, the area forward of the galley (pantry and captain's quarters), and the bunk areas below with the exception of occasionally the first bunk on the right to stow backpacks etc if needed. Check with the captain or demo tech to arrange this.

Areas that are accessible: outside on the main deck, upstairs behind the bridge by the blue life vest chests, the head, the wet lab, and the galley seating area.

IF the galley seating area is to be used for eating for trips longer than 4 hours, then social distancing (6 foot) rules apply while masks are off. If eating or drinking outside, social distancing rules apply.

Persons using the head must sanitize all surfaces after use and use the outside sink under the ladder for hand washing. The door to the Galley should remain closed.

Any of these protocols can be amended or changed by the CSULB safety department or the Captain of the vessel

Vessel and line up zone locations



- ← Line up zones
- ✕ Hand Sanitizer
- R/V Yellowfin



SCMI R/V Yellowfin Check-In & Safety Procedures

1. Students/researcher should go straight to the wharf and line up on the designated markers in front of the R/V Yellowfin. Students should not linger around the front building or front parking lot to avoid overcrowding.
2. The Demo Tech will check in each student/researcher one at a time before they can board the R/V Yellowfin. The check can be done next to the gangway near the lineup markers.

The Demo Tech will verify:

- a. That the student/researcher is wearing close-toed shoes.
 - b. The student/researcher signs the vessel manifest
3. Once all the students/researchers are checked in the Demo Tech should give the safety speech on the dock before they board the vessel.
 4. The COVID-19 safety speech should include:
 - a. Everyone is strongly recommended to wear a mask during the cruise except while eating and drinking.
 - b. Point out the head and sink everyone can use to wash their hands. The sink turns on at the bottom with a kick pedal. Please sanitize the head after use.
 - c. The following areas are off limits to students/researchers
 - i. The bridge
 - ii. The engine room
 - iii. The kitchen part of the galley, the refrigerator is not for guests.
 - iv. The area forward the galley (pantry and captain's quarters)
 - v. The bunk areas
 - d. Students should avoid being inside the galley on short cruises. If the cruise is longer than 4 hours students/researchers can eat in the galley if they remain socially distant (6 feet).

5. Safety Orientation for the R/V Yellowfin

- a. Life vest/pfds(personal floatation devices) are located on the upper deck in the blue bins. In case of emergency the crew will direct passengers to the life vest.
- b. In case of emergency listen to the crew, they will tell you where to muster.
- c. Lifeboats are located on the upper deck in the white round container. This lifeboat will self-inflate when it hits the water.
- d. Man overboard. If a person falls overboard yell “Man Overboard” without taking your eyes off the person. Make sure the crew can hear you and point at the person to keep a visual. Our crew members are trained to get the person out of the water safely. Life rings are located through out the vessel.
- e. Be aware of your surroundings while on the vessel. Always keep one foot on the deck and hold on to railings. Watch out for the corners of the hauls and other trip hazards.
- f. Never walk under the winch wire, go around.
- g. To reach the upper deck use the ladder near the head. Walk up and down facing the ladder.
- h. Keep clear of the stern of the vessel and away from the A-frame and winch.
- i. The Demo Tech will let you know when it is safe to touch the animals.
- j. If you are feeling seasick it is best to say outside and look at the horizon. If sick, please use the outside bottom rail. Do not get sick in the head (toilet).
- k. Please use the sink on the outside of the head or the wet lab sink for washing your hands.
- l. First-aid kits and the AED are in the captain’s cabin behind the galley. All crew members are certified in CPR and First-Aid.